

For Consideration By	Licensing Sub-Committee
Meeting Date	13 December 2022
Type of Notice	TEMPORARY EVENT NOTICE – COUNTER NOTICE
Address of Premises	The Cornershop Bar, 123 Shoreditch High Street, London, E1 6JE
Classification	Decision
Ward(s) Affected	Hoxton East and Shoreditch
Director	Rickardo Hyatt

1. **Summary**

- 1.1. The Metropolitan Police have given the Licensing Authority and the premises user notice of objection to Temporary Event Notice for an event to be held on **29/12/2022** from **02:00am** finishing on **31/12/2022** at **04:00am** at above premises. The Licensing Authority must hold a hearing to decide whether or not to allow the event to proceed.

2. **Current Status/History**

- 2.1. The premises is licensed under the Licensing Act 2003 and the licence document is attached as Appendix C.

3. **TEMPORARY EVENT NOTICE FOR EVENT TO BE HELD 29/12/2022 - 31/12/2022**

- 3.1. A TEN has been submitted to allow licensable activities to take place on the premises. A copy of the Temporary Event Notice is attached as Appendix A.

4. **Objections**

- 4.1. The Metropolitan Police have objected to the TEN on the grounds of the prevention of crime and disorder and the prevention of public nuisance. A copy of the objection is attached as Appendix B.

5. **Guidance Considerations**

- 5.1. That the Licensing Sub-Committee consider the issuing of counter notices if it is satisfied that any of the licensing objectives would be undermined if the premises were to be used in accordance with the temporary event notice.

6. **Policy Considerations**

- 6.1 When considering an objection to a TEN the Council will:

- Expect that any existing conditions will be maintained (where relevant) in circumstances where an event is to take place at a premises that has an existing authorisation.
- Assess any history of complaints as a result of licensable activity that may or may not have been authorised by a TEN.
- Consider the track record of the premises user

- 6.2 Consider any other control measures proposed to mitigate the objection

7. **Human Rights Act 1998 Implications**

- 7.1. **There are implications for;**

- **Article 6** – Right to a fair hearing
- **Article 14** – Not to discriminate
- Balancing; **Article 1**- Peaceful enjoyment of their possession (i.e. a licence is defined as being a possession) with **Article 8** – Right of Privacy (i.e. respect private & family life) to achieve a proportionate decision having regard to the protection of an individuals rights against the interests of the community at large.

8. **Members; Decision Making**

- 8.1. **Option 1**

That the Licensing Authority decides not to give a counter notice.

- 8.2. **Option 2**

That the Licensing Authority decides to give a counter notice, giving the reasons for the decision.

9. **Conclusion**

- 9.1. That Members decide whether or not to issue a counter notice for the event scheduled to take place on **29/12/2022** from **02:00am** finishing on **31/12/2022** at **04:00am** at location **above**.

Appendices:

Appendix A – Temporary Event Notice

Appendix B – Objection from the Responsible Authority

Appendix C – Current Premises Licence

Appendix D – Location Map

Report Author	Name: Suba Sriramana Title: Principal Licensing Officer Email: Subangini.Sriramana@hackney.gov.uk Tel: 020 8356 4915
----------------------	---

Temporary Event Notice

Before completing this notice, please read the guidance notes at the end of the notice. If you are completing this notice by hand, please write legibly in block capitals. In all cases, ensure that your answers are inside the boxes and written in black ink or typed. Use additional sheets if necessary. You should keep a copy of the completed notice for your records. You must send at least one copy of this notice to the licensing authority and additional copies must be sent to the chief officer of police and the local authority exercising environmental health functions for the area in which the premises are situated. The licensing authority will give to you written acknowledgement of the receipt of the notice.

I, the proposed premises user, hereby give notice under section 100 of the Licensing Act 2003 of my proposal to carry on a temporary activity at the premises described below.

1. The personal details of premises user (Please read note 1)			
1. Your name			
Title	Mr <input type="checkbox"/> Mrs <input checked="" type="checkbox"/> Miss <input type="checkbox"/> Ms <input type="checkbox"/> Other (please state)		
Surname	Hussain		
Forenames	Giovanna		
2. Previous names (Please enter details of any previous names or maiden names, if applicable. Please continue on a separate sheet if necessary)			
Title	Mr <input type="checkbox"/> Mrs <input type="checkbox"/> Miss <input type="checkbox"/> Ms <input type="checkbox"/> Other (please state)		
Surname			
Forenames			
3. Your date of birth	<input type="text"/>	Day	Month
4. Your place of birth	<input type="text"/>		
5. National Insurance Number	<input type="text"/>		
6. Your current address (We will use this address to correspond with you unless you complete the separate correspondence box below)			
<input type="text"/>			
<input type="text"/>			
Post town <input type="text"/>		Postcode <input type="text"/>	
7. Other contact details			
Telephone numbers			
Daytime	<input type="text"/>		
Evening (optional)			
Mobile (optional)			
Fax number (optional)			
E-Mail address (if available)	<input type="text"/>		
8. Alternative address for correspondence (If you complete the details below, we will use this address to correspond with you)			
<input type="text"/>			

Post town	Postcode
9. Alternative contact details (if applicable)	
Telephone numbers: Daytime	
Evening (optional)	
Mobile (optional)	
Fax number (optional)	
E-Mail address (if available)	

2. The premises	
Please give the address of the premises where you intend to carry on the licensable activities or, if it has no address, give a detailed description (including the Ordnance Survey references) (Please read note 2)	
The Corner Shop 123 Shoreditch High Street London E1 6JE	
Does a premises licence or club premises certificate have effect in relation to the premises (or any part of the premises)? If so, please enter the licence or certificate number below.	
Premises licence number	LBH-Pre-T-1388
Club premises certificate number	
If you intend to use only part of the premises at this address or intend to restrict the area to which this notice applies, please give a description and details below. (Please read note 3)	
Use of all areas	
Please describe the nature of the premises below. (Please read note 4)	
Bar	
Please describe the nature of the event below. (Please read note 5)	
In House DJ event, Christmas run up.	

--

3. The licensable activities		
Please state the licensable activities that you intend to carry on at the premises (please tick all licensable activities you intend to carry on). (Please read note 6)		
The sale by retail of alcohol	x <input type="checkbox"/>	
The supply of alcohol by or on behalf of a club to, or to the order of, a member of the club	<input type="checkbox"/>	
The provision of regulated entertainment (Please read note 7)	x <input type="checkbox"/>	
The provision of late night refreshment	x <input type="checkbox"/>	
Are you giving a late temporary event notice? (Please read note 8)	<input type="checkbox"/>	
Please state the dates on which you intend to use these premises for licensable activities. (Please read note 9)		
Thursday 29 th December 2022 Friday 30 th December 2022 Saturday 31 st December 2022		
Please state the times during the event period that you propose to carry on licensable activities (please give times in 24-hour clock). (Please read note 10)		
Thursday 29 th December 2022 02:00 until 03:30 for alcohol, 03:30 for LNR and 04:00 for regulated entertainment. Friday 30 th December 2022 02:00 until 03:30 for alcohol, 03:30 for LNR and 04:00 for regulated entertainment. Saturday 31 st December 2022 02:00 until 03:30 for alcohol, 03:30 for LNR and 04:00 for regulated entertainment.		
Please state the maximum number of people at any one time that you intend to allow to be present at the premises during the times when you intend to carry on licensable activities, including any staff, organisers or performers. (Please read note 11)	250	
If the licensable activities will include the sale or supply of alcohol, please state whether these will be for consumption on or off the premises, or both (please tick as appropriate). (Please read note 12)	On the premises only	x <input type="checkbox"/>
	Off the premises only	<input type="checkbox"/>
	Both	<input type="checkbox"/>

Please state if the licensable activities will include the provision of relevant entertainment. If so, please state the times during the event period that you propose to provide relevant entertainment (including, but not limited to lap dancing and pole dancing). (Please see note 13)

No relevant entertainment will take place.

4. Personal licence holders (Please read note 14)		
Do you currently hold a valid personal licence? (Please tick)	Yes <input checked="" type="checkbox"/>	No <input checked="" type="checkbox"/>
If "Yes" please provide the details of your personal licence below.		
Issuing licensing authority	██	
Licence number	████████	
Date of issue		
Any further relevant details		

5. Previous temporary event notices you have given (Please read note 15 and tick the boxes that apply to you)		
Have you previously given a temporary event notice in respect of any premises for events falling in the same calendar year as the event for which you are now giving this temporary event notice?	Yes <input checked="" type="checkbox"/>	No <input type="checkbox"/>
If answering yes, please state the number of temporary event notices (including the number of late temporary event notices, if any) you have given for events in that same calendar year	11	
Have you already given a temporary event notice for the same premises in which the event period: a) ends 24 hours or less before; or b) begins 24 hours or less after the event period proposed in this notice?	Yes <input type="checkbox"/>	No <input checked="" type="checkbox"/>

6. Associates and business colleagues (Please read note 16 and tick the boxes that apply to you)		
Has any associate of yours given a temporary event notice for an event in the same calendar year as the event for which you are now giving a temporary event notice?	Yes <input type="checkbox"/>	No <input checked="" type="checkbox"/>
If answering yes, please state the total number of temporary event notices (including the number of late temporary event notices, if any) your associate(s) have given for events in the same calendar year.		
Has any associate of yours already given a temporary event notice for the same premises in which the event period: a) ends 24 hours or less before; or	Yes <input type="checkbox"/>	No <input checked="" type="checkbox"/>

b) begins 24 hours or less after the event period proposed in this notice?		
Has any person with whom you are in business carrying on licensable activities given a temporary event notice for an event in the same calendar year as the event for which you are now giving a temporary event notice?	Yes <input type="checkbox"/>	No x <input type="checkbox"/>
If answering yes, please state the total number of temporary event notices (including the number of late temporary event notices, if any) your business colleague(s) have given for events in the same calendar year.		
Has any person with whom you are in business carrying on licensable activities already given a temporary event notice for the same premises in which the event period: a) ends 24 hours or less before; or b) begins 24 hours or less after the event period proposed in this notice?	Yes <input type="checkbox"/>	No x <input type="checkbox"/>

7. Checklist (Please read note 17)	
I have: (Please tick the appropriate boxes, where applicable)	
Sent at least one copy of this notice to the licensing authority for the area in which the premises are situated	x <input type="checkbox"/>
Sent a copy of this notice to the chief officer of police for the area in which the premises are situated	x <input type="checkbox"/>
Sent a copy of this notice to the local authority exercising environmental health functions for the area in which the premises are situated	x <input type="checkbox"/>
If the premises are situated in one or more licensing authority areas, sent at least one copy of this notice to each additional licensing authority	<input type="checkbox"/>
If the premises are situated in one or more police areas, sent a copy of this notice to each additional chief officer of police	<input type="checkbox"/>
If the premises are situated in one or more local authority areas, sent a copy of this notice to each additional local authority exercising environmental health functions	<input type="checkbox"/>
Made or enclosed payment of the fee for the application	x <input type="checkbox"/>
Signed the declaration in Section 9 below	x <input type="checkbox"/>

8. Condition (Please read note 18)
It is a condition of this temporary event notice that where the relevant licensable activities described in Section 3 above include the sale or supply of alcohol that all such supplies are made by or under the authority of the premises user.

9. Declarations (Please read note 19)
--

The information contained in this form is correct to the best of my knowledge and belief.	
I understand that it is an offence: (i) to knowingly or recklessly make a false statement in or in connection with this temporary event notice and that a person is liable on summary conviction for such an offence to a fine of any amount; and (ii) to permit an unauthorised licensable activity to be carried on at any place and that a person is liable on summary conviction for any such offence to a fine of any amount, or to imprisonment for a term not exceeding six months, or to both.	
Signature	
Date	24.11.22
Name of Person signing	Guy Hicks – Raven Consultants

For completion by the licensing authority

10. Acknowledgement (Please read note 20)	
I acknowledge receipt of this temporary event notice.	
Signature	On behalf of the licensing authority
Date	
Name of Officer signing	



TENs x2 for the Corner Shop

1 message

HackneyLicensingUnit-GN@met.police.uk <HackneyLicensingUnit-GN@met.police.uk>

28 November 2022 at 11:16

To: licensing@hackney.gov.uk, environmental.protection@hackney.gov.uk

Cc: HackneyLicensingUnit-GN@met.police.uk, [REDACTED]

Dear All,

Police object to the TENs submitted for the 23rd/24th and the 29th-31st as we are unable to assess these event's impact on the licensing objectives until such times as earlier events have passed without incident.

Regards

Neal



PC Neal Hunwick 3590CE

Central East Licensing Unit

Metropolitan Police Service (MPS)

T: 02072753688 M: 07884561629 Email Neal.Hunwick@met.police.uk

A: Licensing Office, Stoke Newington Police Station, 33 Stoke Newington High Street, London, N18 8DS

NOTICE - This email and any attachments are solely for the intended recipient and may be confidential. If you have received this email in error, please notify the sender and delete it from your system. Do not use, copy or disclose the information contained in this email or in any attachment without the permission of the sender. Metropolitan Police Service (MPS) communication systems are monitored to the extent permitted by law and any email and/or attachments may be read by monitoring staff. Only specified personnel are authorised to conclude binding agreements on behalf of the MPS by email and no responsibility is accepted for unauthorised agreements reached with other personnel. While reasonable precautions have been taken to ensure no viruses are present in this email, its security and that of any attachments cannot be guaranteed.



This premises licence has been issued by:

Licensing Service
1 Hillman Street
London E8 1DY

PART A – PREMISES LICENCE

Premises Licence Number

LBH-PRE-T-1388

Part 1 – Premises details

The Corner Shop
123 Shoreditch High Street
Hackney
London
E1 6JE

Where the licence is time limited the dates

Not Applicable

Licensable activities authorised by the licence

Films
Live Music
Recorded Music
Performance of Dance
Other Entertainment Similar to Live or Rec Music or Dance Performance
Late Night Refreshment
Supply of Alcohol

The times the licence authorises the carrying out of licensable activities

Films

Standard Hours:

Premises:

Mon 10:00-01:00
Tue 10:00-01:00
Wed 10:00-01:00
Thu 10:00-02:00
Fri 10:00-02:00
Sat 10:00-02:00
Sun 12:00-00:00

Live Music
Premises:

Standard Hours:
Mon 10:00-01:00
Tue 10:00-01:00
Wed 10:00-01:00
Thu 10:00-02:00
Fri 10:00-02:00
Sat 10:00-02:00
Sun 12:00-00:00

Recorded Music
Premises:

Standard Hours:
Mon 10:00-01:00
Tue 10:00-01:00
Wed 10:00-01:00
Thu 10:00-02:00
Fri 10:00-02:00
Sat 10:00-02:00
Sun 12:00-00:00

Performance of Dance
Premises:

Standard Hours:
Mon 10:00-01:00
Tue 10:00-01:00
Wed 10:00-01:00
Thu 10:00-02:00
Fri 10:00-02:00
Sat 10:00-02:00
Sun 12:00-00:00

Other Entertainment Similar to Live or Rec Music or Dance Performance
Premises:

Standard Hours:
Mon 10:00-01:00
Tue 10:00-01:00
Wed 10:00-01:00
Thu 10:00-02:00
Fri 10:00-02:00
Sat 10:00-02:00
Sun 12:00-00:00

Late Night Refreshment
Premises:

Standard Hours:
Mon 23:00-01:00
Tue 23:00-01:00
Wed 23:00-01:00
Thu 23:00-02:00
Fri 23:00-02:00
Sat 23:00-02:00
Sun 23:00-00:00

Supply of Alcohol Standard Hours:

Premises: Mon 10:00-01:00
 Tue 10:00-01:00
 Wed 10:00-01:00
 Thu 10:00-02:00
 Fri 10:00-02:00
 Sat 10:00-02:00
 Sun 12:00-00:00

The opening hours of the premises

Standard Hours:

Mon 10:00-01:00
Tue 10:00-01:00
Wed 10:00-01:00
Thu 10:00-02:00
Fri 10:00-02:00
Sat 10:00-02:00
Sun 12:00-00:00

Where the licence authorises supplies of alcohol whether these are on and/or off supplies

On and Off Premises

Part 2 –

Name, (registered) address, telephone number and e-mail (where relevant) of holder of premises licence

Shoreditch 123 Limited
123 Shoreditch High Street
London
E1 6JE

Registered number of holder, for example company number, charity number (where applicable)

09150237

Name, address and telephone number of designated premises supervisor where the premises authorises the supply of alcohol

Julija Vychovanec

Personal licence number and issuing authority of personal licence held by designated premises supervisor where the premises licence authorises the supply of alcohol

Date of Grant: 9 April 2013

Signed:

**David Tuitt
Team Leader - Licensing**

Annex 1 - Mandatory Conditions

Supply of Alcohol (On/Both):

1. No supply of alcohol may be made under the premises licence:
 - (a) At a time when there is no designated premises supervisor in respect of the premises licence.
 - (b) At a time when the designated premises supervisor does not hold a personal licence or his personal licence is suspended.
2. Every supply of alcohol under the premises licence must be made or authorised by a person who holds a personal licence.
3. (1) The responsible person must ensure that staff on relevant premises do not carry out, arrange or participate in any irresponsible promotions in relation to the premises.
 - (2) In this paragraph, an irresponsible promotion means any one or more of the following activities, or substantially similar activities, carried on for the purpose of encouraging the sale or supply of alcohol for consumption on the premises -
 - (a) games or other activities which require or encourage, or are designed to require or encourage, individuals to;
 - (i) drink a quantity of alcohol within a time limit (other than to drink alcohol sold or supplied on the premises before the cessation of the period in which the responsible person is authorised to sell or supply alcohol), or
 - (ii) drink as much alcohol as possible (whether within a time limit or otherwise);
 - (b) provision of unlimited or unspecified quantities of alcohol free or for a fixed or discounted fee to the public or to a group defined by a particular characteristic in a manner which carries a significant risk of undermining a licensing objective;
 - (c) provision of free or discounted alcohol or any other thing as a prize to encourage or reward the purchase and consumption of alcohol over a period of 24 hours or less in a manner which carries a significant risk of undermining a licensing objective;
 - (d) selling or supplying alcohol in association with promotional posters or flyers on, or in the vicinity of, the premises which can reasonably be considered to condone, encourage or glamorise anti-social behaviour or to refer to the effects of drunkenness in any favourable manner.

(e)dispensing alcohol directly by one person into the mouth of another (other than where that other person is unable to drink without assistance by reason of a disability).

4. The responsible person must ensure that free potable water is provided on request to customers where it is reasonably available.
- 5.5.1. The premises licence holder or club premises certificate holder must ensure that an age verification policy is adopted in respect of the premises in relation to the sales or supply of alcohol.
- 5.2 The designated premises supervisor in relation to the premises licences must ensure that the supply of alcohol at the premises is carried on in accordance with the age verification policy.
- 5.3. The policy must require individuals who appear to the responsible person to be under 18 years of age (or such older age as may be specified in the policy) to produce on request, before being served alcohol, identification bearing their photograph, date of birth and either:-
 - (a) a holographic mark or
 - (b) an ultraviolet feature
6. The responsible person must ensure that:
 - a) where any of the following alcoholic drinks is sold or supplied for consumption on the premises (other than alcoholic drinks sold or supplied having been made up in advance ready for sale or supply in a securely closed container) it is available to customers in the following measures:
 - beer or cider:1/2 pint;
 - gin, rum, vodka or whisky: 25ml or 35ml; and
 - still wine in a glass: 125ml; and
 - b) these measures are displayed in a menu, price list or other printed material which is available to customers on the premises; and
 - c)where a customer does not in relation to a sale of alcohol specify the quantity of alcohol to be sold, the customers is made aware that these measures are available.

Minimum Drinks Pricing

7. 7.1 A relevant person shall ensure that no alcohol is sold or supplied for consumption on or off the premises for a price which is less than the permitted price.

7.2 For the purposes of the condition set out in paragraph 7.1 above

(a) “duty” is to be construed in accordance with the Alcoholic Liquor Duties Act 1979;

(b) “permitted price” is the price found by applying the formula -

$$P = D+(D \times V)$$

Where -

(i) P is the permitted price,

(ii) D is the rate of duty chargeable in relation to the alcohol as if the duty were charged on the date of the sale or supply of the alcohol, and

(iii) V is the rate of value added tax chargeable in relation to the alcohol as if the value added tax were charged on the date of the sale or supply of the alcohol;

(c) “relevant person” means, in relation to premises in respect of which there is in force a premises licence -

(i) the holder of the premises licence,

(ii) the designated premises supervisor (if any) in respect of such a licence, or

(iii) the personal licence holder who makes or authorises a supply of alcohol under such a licence;

(d) “relevant person” means, in relation to premises in respect of which there is in force a club premises certificate, any member or officer of the club present on the premises in a capacity which enables the member or officer to prevent the supply in question; and

(e) “value added tax” means value added tax charged in accordance with the Value Added Tax Act 1994.

7.3 Where the permitted price given by Paragraph 7.2(b) above would (apart from this paragraph) not be a whole number of pennies, the price given by that sub-paragraph shall be taken to be the price actually given by that sub-paragraph rounded up to the nearest penny.

7.4 (1) Sub-paragraph 7.4(2) below applies where the permitted price given by Paragraph 7.2(b) above on a day (“the first day”) would be different from the permitted price on the next day (“the second day”) as a result of a change to the rate of duty or value added tax.

(2) The permitted price which would apply on the first day applies to sales or supplies of alcohol which take place before the expiry of the period of 14 days beginning on the second day.

Exhibition of Films

8. Admission of children (under 18) to the exhibition of any film must be restricted in accordance with: -
 - (a) Recommendations made by the film classification body where the film classification body is specified in the licence, or
 - (b) Recommendations made by the licensing authority where the film classification body is not specified in the licence, or the relevant licensing authority has not notified the holder of the licence that this subsection applies to the film in question.

"film classification body" means person('s) designated under s4 of the Video Recordings Act 1984(c.39).

Door Supervision

9. Each individual who is to carry out a security activity at the premises must be licensed by the Security Industry Authority.

Annex 2 – Conditions consistent with the Operating Schedule

10. The premises shall maintain a comprehensive CCTV system as per the minimum requirements of a Metropolitan Police Crime Prevention Officer. All entry and exit points will be covered enabling frontal identification of every person entering in any light condition. The CCTV system shall continually record whilst the premises is open for licensable activities and during all times when customers remain on the premises. All recordings shall be stored for a minimum period of 31 days with date and time stamping. Recordings shall be made available immediately upon the request of Police or authorised officer.
- 10a. A staff member from the premises who is conversant with the operation of the CCTV system shall be on the premises at all times when the premises are open to the public. This staff member shall be able to show Police or an authorised officer of Hackney Borough Council recent data or footage with the absolute minimum of delay when requested.
11. Non-intoxicating beverages, including drinking water, shall be made available throughout the permitted hours in all parts of the premises where alcohol is served.
12. An incident log shall be kept at the premises and made available immediately to an authorised officer of the Council or Police, which will record the following:
 - a. all crimes reported to the venue

- b. all ejections of patrons
 - c. any complaints received
 - d. any incidents of disorder
 - e. seizures of drugs or offensive weapons
 - f. any refusal of the sale of alcohol
13. The premises will display and maintain appropriate signage advising customers of the contact details of the Designated Premises Supervisor.
 14. All windows and doors shall remain closed at all times when regulated entertainment is being played except for access and egress.
 15. Signs to be placed at all exits requesting customers to leave the area quietly.
 16. Refuse, including bottles, shall not be taken outside the premises between the hours of 23.00 and 07.00 or such other times.
 17. The pavement from the building line to the kerb edge immediately outside the premises, including gutter/channel at its junction with the kerb edge, shall be swept and or washed, and litter and sweepings collected and stored in accordance with the approved refuse storage arrangements.
 18. Key members of staff shall be trained to make customers aware of the laws regarding sales or purchase of alcohol on behalf of children.
 19. Where the sale or supply of alcohol is taking place employees of the premises must request sight of evidence of the age of any person appearing to be under 21 years of age (Challenge 21). Such evidence may include a driving licence or passport.

Conditions derived from Responsible Authority representations

20. The venue will comply with the Hackney Police Search and seizure Policy 2011 (or as amended) and the Hackney Police Theft reduction Policy 2011 (or as amended)
21. The premises are to draw up and implement policies, approved by the police licensing unit and/or Crime and Prevention Officer, dealing with the following: Entry and Search Policy, Drugs Policy, Queuing, Smoking and Dispersal Policy, Security Policy, Weapons Policy
22. Premises to regularly facilitate a premises drug audit using the Ion Itemizer or similar device.
23. A minimum of one SIA registered door staff per 100 customers or part thereof shall be on duty from 22:00 hours on Thursdays to Saturdays. Where possible, the numbers should include one (1) Female SIA. From 21:00 hours a minimum of two (2) SIA will be stationed at the front entrance (and will count in/out customers using a mechanical counter) Additional Male and Female SIA door staff to be employed at the premises when required on the basis of

an operational risk assessment. There should be sufficient SIA to monitor all areas in use.

24. All door supervisors shall enter their full details in the premises daily register at the commencement of their work. They shall record their full name, home address and contact telephone number, their SIA registration number, and the time they commence and conclude working. If the door supervisor was provided by an agency the name, registered business address and contact telephone number will also be recorded. This register will be made available to police or authorised officer immediately upon request.
25. All door supervisors will have access to and use of radio links to advise management of any crime and disorder problems.
26. There will be regular first aid training on the premises.
27. After 23:00 patrons cannot take glass or open containers outside the front of the premises to the street but if no permission is in place the time shall revert to 21:00 or such other time as agreed with the police.
28. Reasonable steps to be taken to ensure that an authorised person is a member of Pubwatch and SNOW and attends at least six meetings a year.
29. There shall be regular toilet checks on Thursday, Friday and Saturday
30. All staff employed at the premises should be over 18 years old and photo identification has been seen to confirm this.
31. The Licence Holder shall provide and maintain a dedicated phone number of senior management and/or the Designated Premises Supervisor for use by any Responsible Authority or any person who may wish to make a comment during the operation of the licence. This shall be provided to the Licensing Authority, Police and local Residents Associations. The Licence Holder shall ensure that any changes in these details are sent to these parties within seven days of the change.
32. On Thursday, Friday and Saturdays there shall be a personal licence holder on the premises from 1800 hours until close.
33. Prominent signage indicating the permitted hours for the sale of alcohol shall be displayed so as to be visible before entering the premises, where alcohol is on public display, and at the point of sale and notices to be displayed at exits requesting that patrons respect the needs of local residents and leave the premises and the area quietly.
34. All staff shall be given refresher training on the legislation relating to sales of alcohol to underage persons, drunken persons and how to deal with people incapacitated by drink or drugs every twelve months. Records of the training to be kept at the venue and made available to police or authorised officer immediately upon request.

35. Key members of staff shall be trained to make customers aware of the laws regarding sales or purchase of alcohol on behalf of children
36. The premises licence holder shall support and promote the night time economy team with any scheme brought in to assist with the promotion of the four licensing objectives in the Shoreditch Triangle.
37. a) There will be no entry or re-entry to customers after 1am or such later time as agreed with the police, except patrons who have temporarily left the premises to smoke.
- b) Whilst there is a TEN in place the last entry shall be one hour before the terminal hour of the event or such later time as may be agreed by the Police.
38. The licence holder shall carry out regular checks to ensure compliance with all the conditions of the licence which may include the use of mystery shoppers.
39. There shall be no more than 300 customers at the premises at any one time.

Annex 3 – Conditions attached after a hearing by the licensing authority

40. There will be no more than 20 patrons smoking at any one time outside the premises and the smoking area shall be clearly identified.
41. All instances of crime or disorder to be reported by the designated premises supervisor or responsible member of staff to an agreed police contact point, as agreed with the Police.

Annex 4 – Plans

PLAN\LBH-PRE-T-1388\13052019

Shoreditch High Street

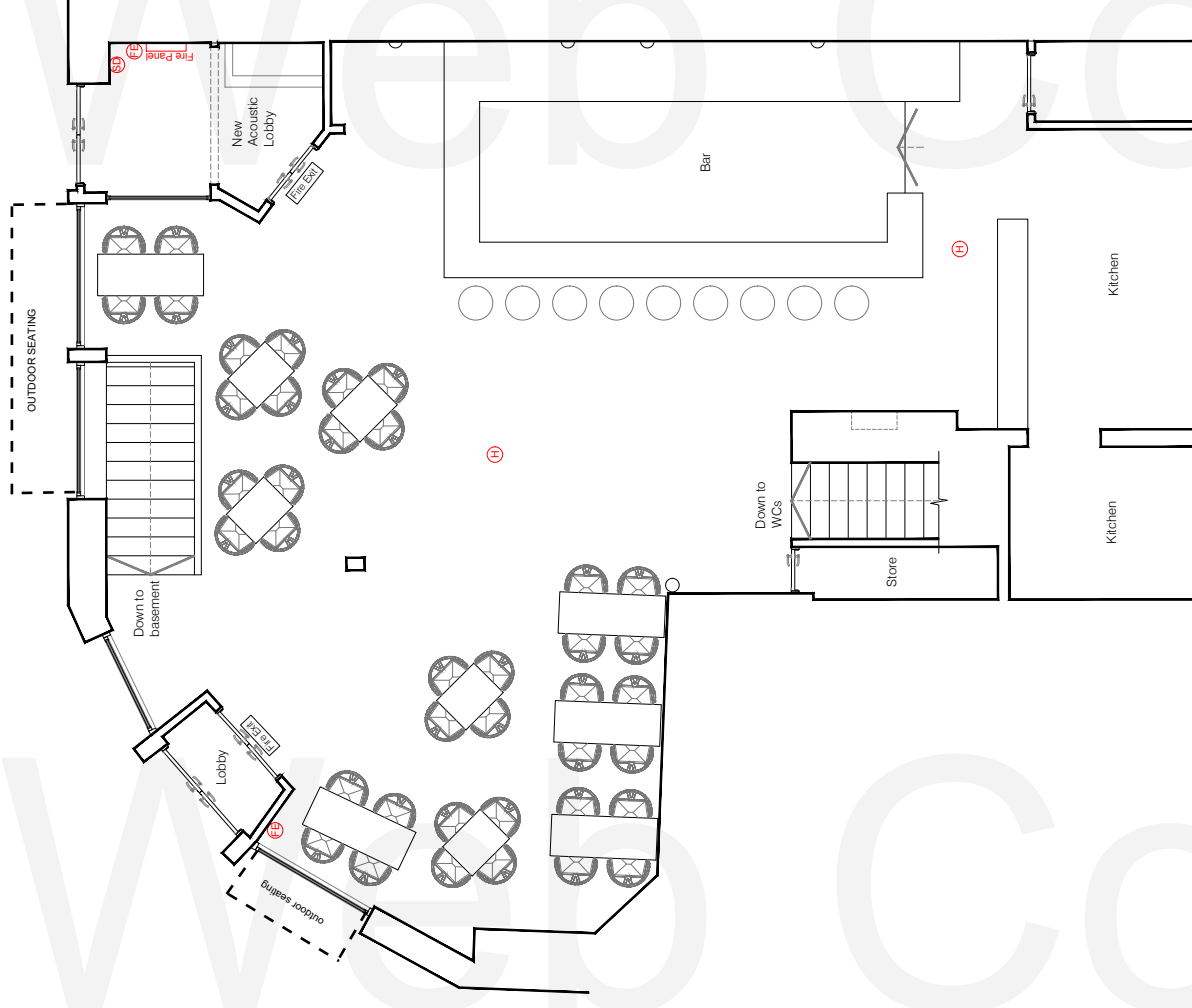

Ground Floor Plan

IMPORTANT:- Licensable activities can take place anywhere within the premises. The position of loose furniture and equipment is shown for diagrammatic purposes only. Firefighting equipment is indicated but may be moved subject to the fire risk assessment carried out under the Regulatory Reform (Fire Safety) Order 2005 or by agreement with the fire officer.

Fire Key	
(H)	Heat/Smoke Detector
(SD)	Alarm Sounder
(FE)	Fire Extinguisher
[Fire Exit]	Means of Escape/Fire Door

Carter Designs

Address
81A Oliley Road,
Harrogate
HG2 0DU

Address
2 Michael Road,
Cooper House,
Unit 3U
London
SW6 2AD

T: +44(0) 7701 014 500
E: mail@carter-designs.com
W: www.carter-designs.com

LICENCE PLAN

Project Title:
Licence Plan - The Cornershop
122 Shoreditch High Street, London, E1 6JE

Drawing Title:
Ground Floor Plan

Project No.: 086-18
Drawing No.: 1001
Rev.: -
Scale: 1:100 @A3

Rev.: Description.: Date.: Initial by.:

Note:
Do not scale this drawing. All dimensions and setting out must be checked on site prior to Construction/Manufacture. Any errors to be highlighted to Carter Designs. All rights reserved. No reproduction in any material form is permitted without consent. Copyright Carter Design Studio Ltd 2018 ©

Shoreditch High Street

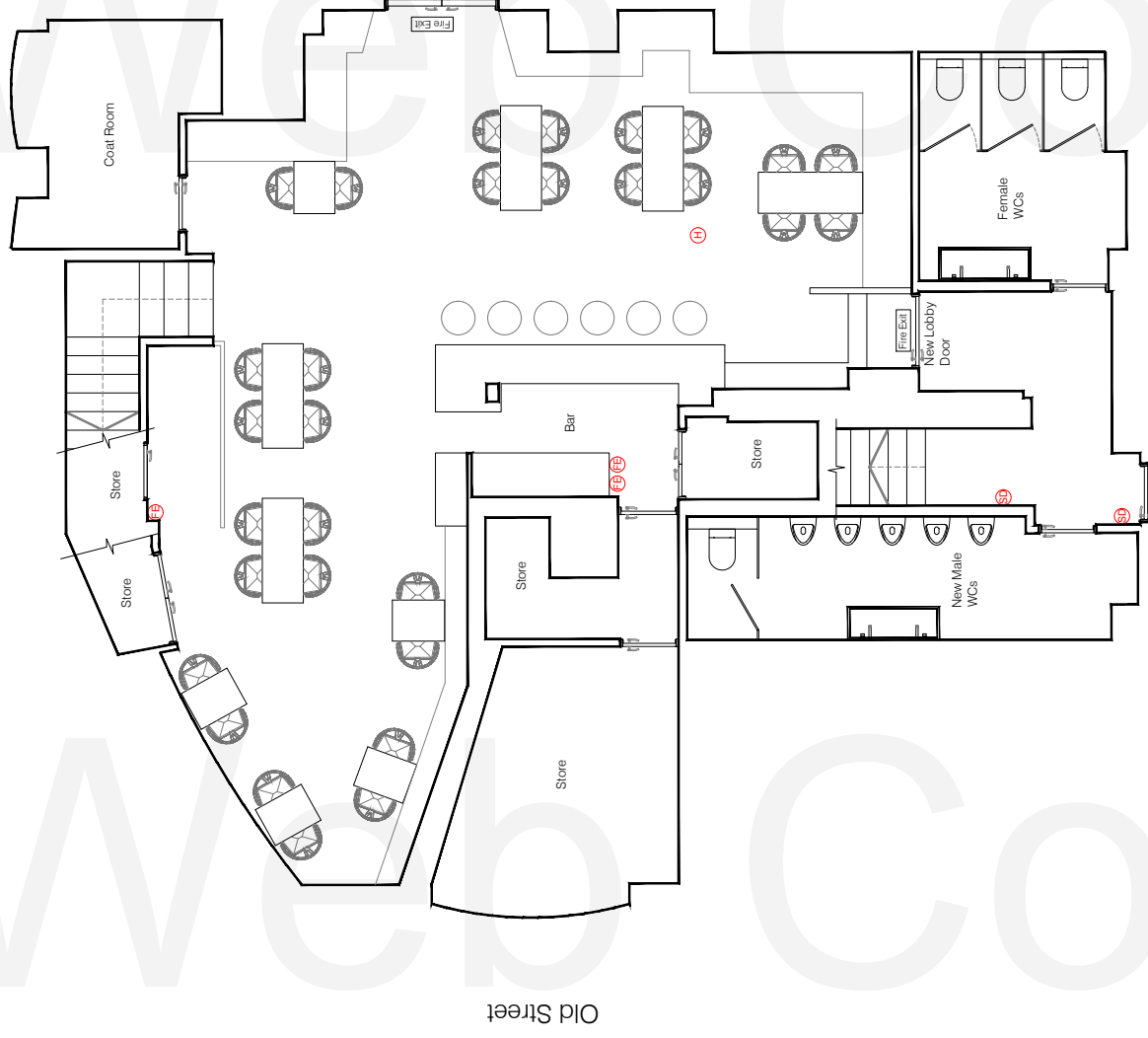

Basement Floor Plan

IMPORTANT:- Licensable activities can take place anywhere within the premises. The position of loose furniture and equipment is shown for diagrammatic purposes only. Firefighting equipment is indicated but may be moved subject to the fire risk assessment carried out under the Regulatory Reform (Fire Safety) Order 2005 or by agreement with the fire officer.

Fire Key	
(H)	Heat/Smoke Detector
(SD)	Alarm Sounder
(FE)	Fire Extinguisher
[Fire Exit]	Means of Escape/Fire Door

LICENCE PLAN

Rev.:	Description.:	Date.:	Initial by.:
<p>Note: Do not scale this drawing. All dimensions and setting out must be checked on site prior to Construction/manufacture. Any errors to be highlighted to Carter Designs. All rights reserved. No reproduction in any material form is permitted without consent. Copyright Carter Design Studio Ltd 2018 ©</p>			

Project Title:	Licence Plan - The Cornershop
	122 Shoreditch High Street, London, E1 6JE
Drawing Title:	Basement Floor Plan
Project No.:	086-18
Drawing No.:	1000
Rev.:	-
Scale:	1:100 @A3

Carter Designs

Address	Address
81A Olley Road, Harrogate HG2 0DU	2 Michael Road, Cooper House, Unit 3U London SW6 2AD
T: +44(0) 7701 014 500	
E: mail@carter-designs.com	
W: www.carter-designs.com	

Appendix D

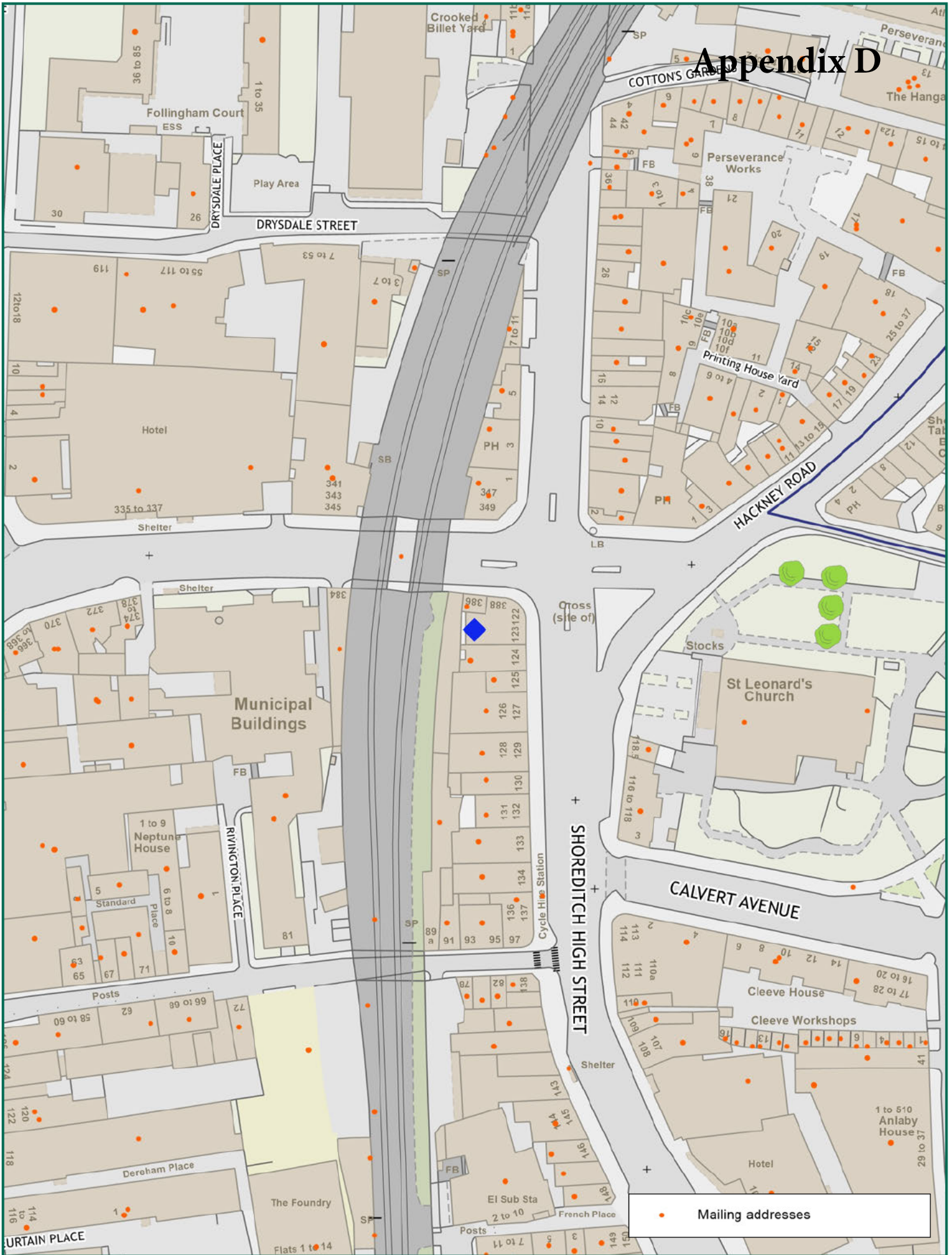

• Mailing addresses

NORTH

Scale: 1:1250 at A4

Hackney

The Cornershop, 123 Shoreditch High Street, London, E1 6JE

Ref:

Produced by: unspecified

please specify copyright statement

Wednesday, December 7, 2022

email: